



21 Belton Street ANGLESEA VIC

5 3 2

Is an understatement to this substantial and solid coastal property.

This is the perfect coastal property to accommodate the largest of families or extended family and friends with five bedrooms (the fifth can be utilised as a rumpus room) and three bathrooms coupled with a generous open plan living area. The large and expansive deck offers a lovely north facing treed aspect with broad views of the Anglesea Golf Course and beyond to the Anglesea Heath.

An unexpected additional to this substantial property is an indoor swimming pool and spa (solar and gas heated with automatic water filtering) with an outstanding indoor entertainment zone equipped with a kitchenette, air conditioner and wet area that could also be used as an all year round gym. Secure rear yard, ample off street

Type : House
Land Size : 867 sqm
View : <https://www.greatoceanproperties.com.au/3221468>



Marty Maher
0352200000

[For full version visit the website](https://www.greatoceanproperties.com.au)

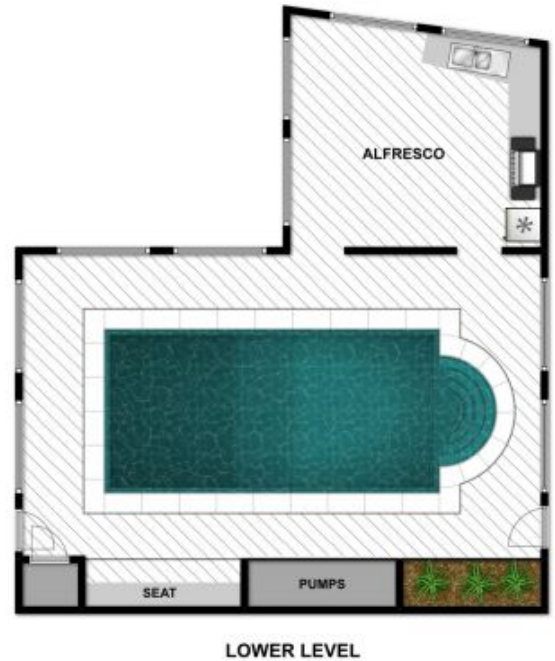
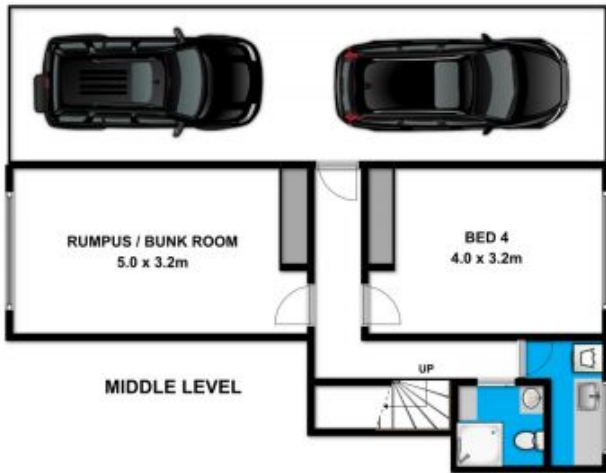

Whilst bwrn.com.au has made every attempt to ensure the accuracy of the floor plan contained here, measurements are approximate and no responsibility is taken for any error, omission, or mis-statement. This plan is for illustrative purposes only.



21 Belton Street

Anglesea