



87 Noble Street ANGLESEA VIC

3 2 2

OFFERS REQUIRED BY 1 MAY 2017

Nestled amongst the trees, this coastal property captures beautiful and elevated views of the Anglesea golf course and beyond to the Anglesea Heath. Watch the ever-changing panorama and wildlife from this elevated position.

You are within pitching distance to the 12th green of the famous Anglesea Golf Club and within walking distance to the village, the general store and Main Beach.

The well constructed and designed home is evident with the main living area, two bedrooms and two bathrooms located on the entry level ideal for those wanting to downsize.

You will find an abundance of natural light to the spacious open plan kitchen/living and dining area; framed by glass to

Type : House
Land Size : 560 sqm
View : <https://www.greatoceanproperties.com.au/3574911>



Marty Maher
0352200000

[For full version visit the website](https://www.greatoceanproperties.com.au)



Entry Level

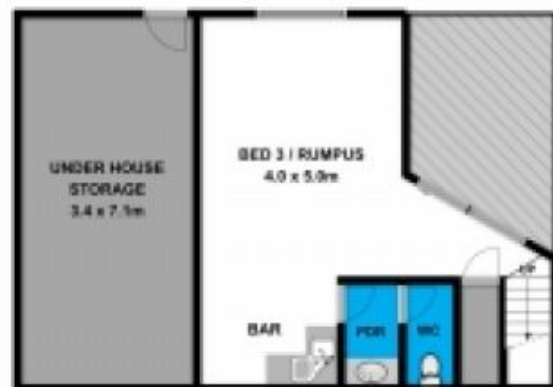

Lower Level

Whilst www.realestate.com.au has made every attempt to ensure the accuracy of the floor plan contained here, measurements are approximate and no responsibility is taken for any errors, omissions, or mis-statements. This plan is for illustrative purposes only.

