



### 38 Noel Street APOLLO BAY VIC

4 2 3

This four-bedroom home boasts some of the best sea and mountain views in 'The Bay', which cannot be built out. It truly is one of the finest homes we have had the privilege to offer to the market.

The upper level includes open plan lounge and dining areas, and a huge deck and private entertaining area. Massive picture windows open to the north and east, enjoying the spectacular views.

The central kitchen includes an island bench/breakfast bar, 'Ceasar-Stone' bench tops and a Butler's pantry /scullery. A Powder room/third toilet services the upstairs area.

A central feature to the house is a Margaret River Limestone wall, an elegant open stair case and recycled 'Messmate' polished floor boards through-out.

**Type** : House  
**Price** : \$ 1,480,000  
**Land Size** : 800 sqm  
**View** : <https://www.greatoceanproperties.com.au/4698450>



**Gary Van Someren**  
**0418550049**

[For full version visit the website](https://www.greatoceanproperties.com.au)

<https://www.greatoceanproperties.com.au>

03 52377 366

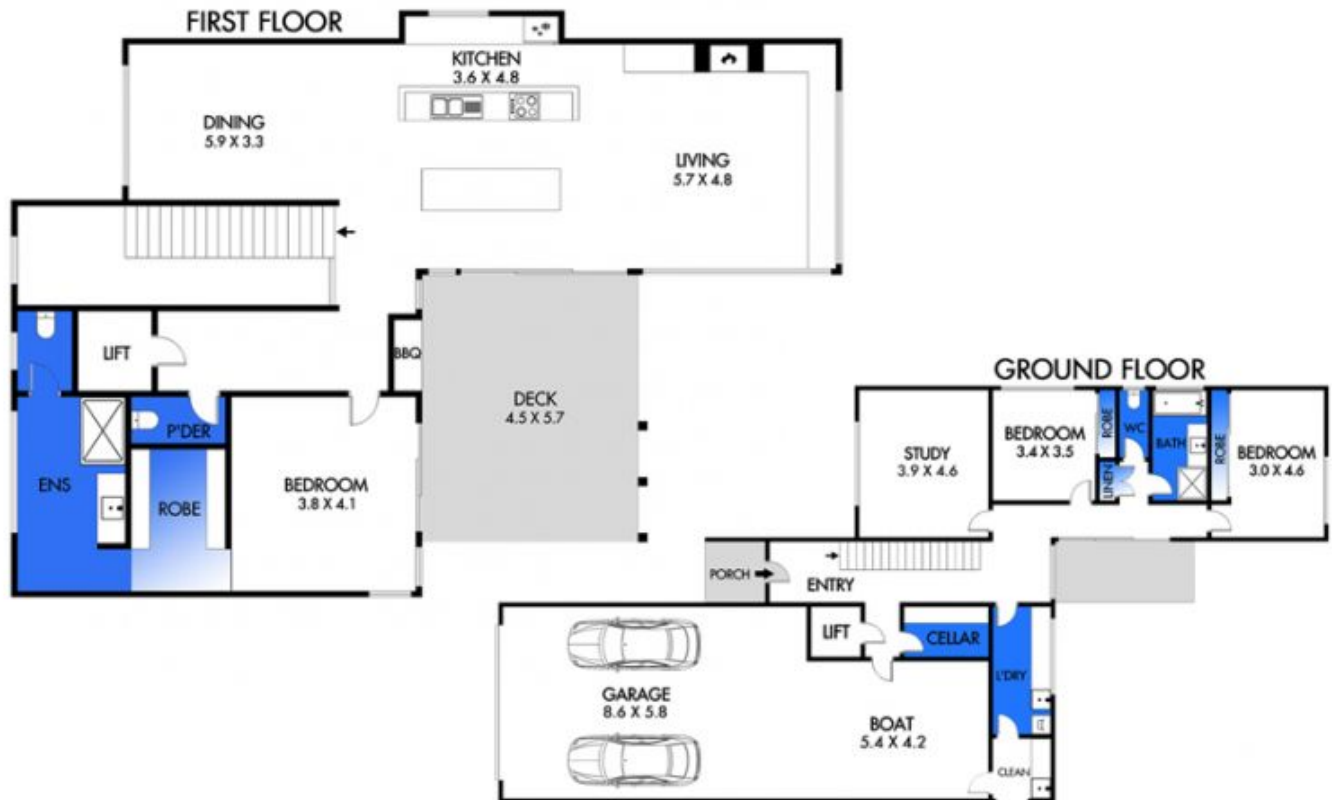

DISCLAIMER: PLEASE NOTE PLANS ARE INDICATIVE ONLY AND NOT DRAWN TO EXACT SCALE. ALL DIMENSIONS ARE APPROXIMATE. POTENTIAL BUYERS SHOULD VIEW THE PROPERTY IN PERSON.