



2 Purnell Street ANGLESEA VIC

2 2 4

This is sunny and spacious single level living located beach side of the Great Ocean Road and is perfect for anyone who loves a relaxed coastal lifestyle with everything you need just moments away.

Soaring ceilings and generous glazing have created a light filled and airy open plan living area. This is the central hub and it features an extensive kitchen and effortless flow out to the north-facing courtyard. Both bedrooms enjoy the northerly aspect and have an en-suite and walk-in robe. The master is adjacent to a second living zone and study. There is plenty of scope to easily add a third or fourth bedroom without extending the footprint, with the added benefit of the 1062sqm (app) site offering the opportunity for an extension if required (STCA).

[For full version visit the website](https://www.greatoceanproperties.com.au/5151644)

Type : House
Price : \$ 1,100,000
Land Size : 1027 sqm
View : <https://www.greatoceanproperties.com.au/5151644>



Marty Maher
0352200000

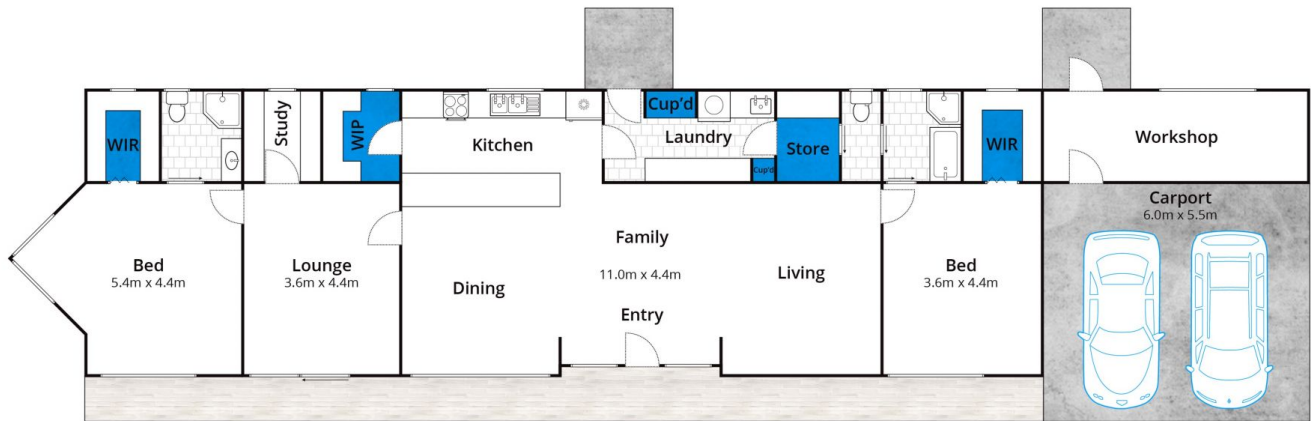

Approx. Area 158m²

Whilst bwrm.com.au has made every attempt to ensure the accuracy of the floor plan contained here, measurements are approximate and no responsibility is taken for any error, omission, or mis-statement. This plan is for illustrative purposes only.

2 Purnell Street, Anglesea

