



235 Great Ocean Road ANGLESEA VIC

3 2 4

THIS PROPERTY CAN BE VIEWED BY PRIVATE OR FACETIME APPOINTMENT

Take a classic beach cottage, extend, update and imbue with contemporary coastal hues and the result is this delightful welcoming home with ocean views. Currently enjoyed for its simplicity and loved as a beach home retreat, this property offers an incredible opportunity to maximise its 1391sqm (approx.) allotment and uncover the potential panoramic vista from a second storey (STCA). Imagine uninterrupted views from Pt Addis to Lorne. Extensive glazing in the open plan living zone invites in copious natural light and showcases the stunning ocean outlook. Beautiful timber floors add charm and the interior

[For full version visit the website](https://www.greatoceanproperties.com.au/5304683)

Type : House
Land Size : 1156 sqm
View : <https://www.greatoceanproperties.com.au/5304683>



Marty Maher
0352200000

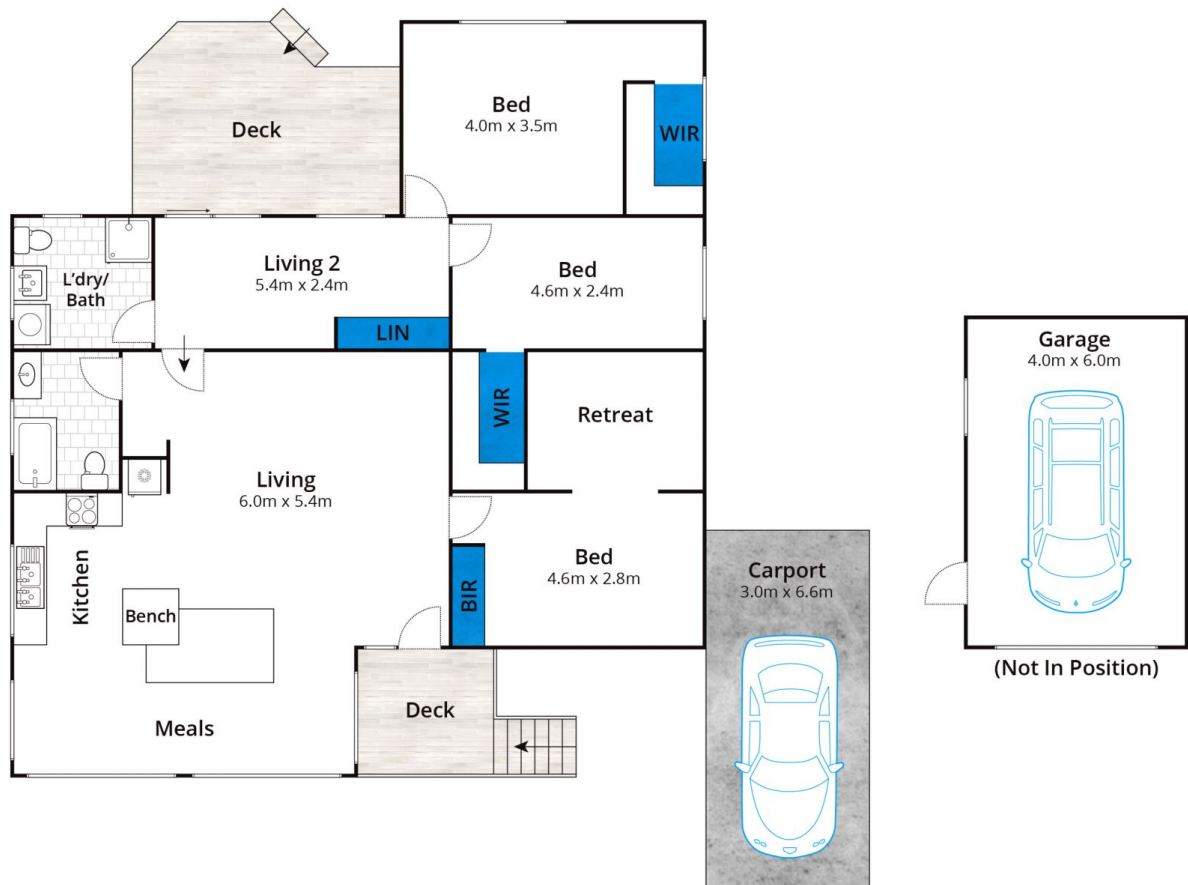

Approx House Area 135m²

Whilst bwrm.com.au has made every attempt to ensure the accuracy of the floor plan contained here, measurements are approximate and no responsibility is taken for any error, omission, or mis-statement. This plan is for illustrative purposes only.

235 Great Ocean Road, Anglesea

