



## 72A The Esplanade TORQUAY VIC

3 2 2

Front row dress circle position across the road from one of Australia's premier beach locations, this master-built property is centrally located between Old Torquay & the new Torquay North. This unique opportunity will be a popular choice, with a flexible & versatile design that includes self-contained living & world-class ocean views guaranteed from both levels. This well-positioned property near Torquay's restaurant precinct will appeal to many, & families will enjoy safe swimming & surfing at protected Fisherman's Beach.

The ground level offers open plan living, kitchen & dining, where all eyes are firmly transfixed on the deep blue sea views, stretching from Zeally Bay to Cape Schanck. Sliding doors open to a covered front deck & immaculate lawn,

**Type** : House  
**Land Size** : 405 sqm  
**View** : <https://www.greatoceanproperties.com.au/5577687>



**Marty Maher**  
0352200000



**Michelle McDonald**  
0352631100

[For full version visit the website](https://www.greatoceanproperties.com.au)

<https://www.greatoceanproperties.com.au>

5220 0000

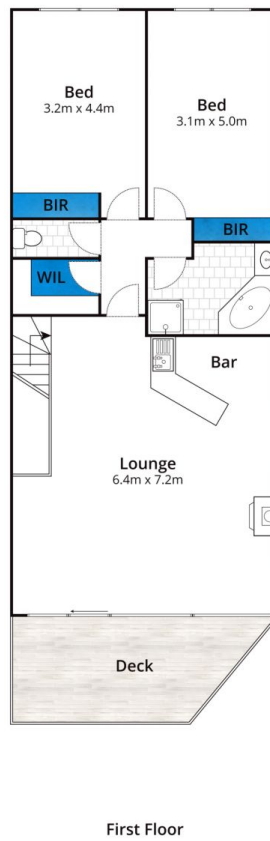
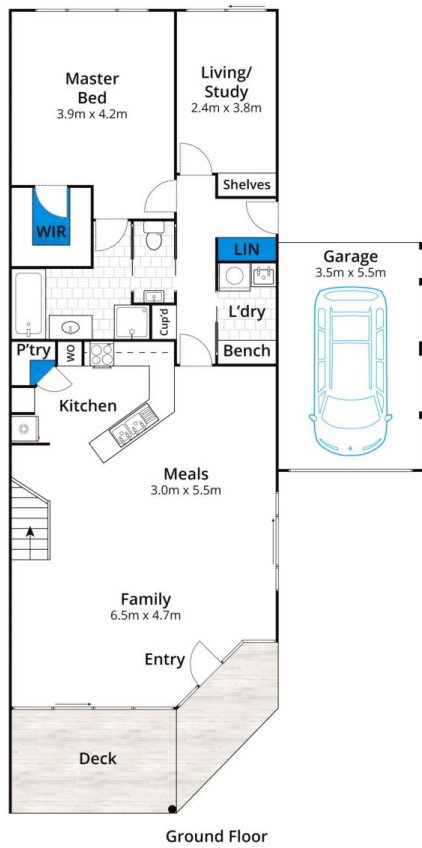

Approx House Area 209m<sup>2</sup>

Whilst [bwrm.com.au](http://bwrm.com.au) has made every attempt to ensure the accuracy of the floor plan contained here, measurements are approximate and no responsibility is taken for any error, omission, or mis-statement. This plan is for illustrative purposes only.

## 72A The Esplanade, Torquay

