



4/137 Great Ocean Road ANGLESEA VIC

3  **2**  **2** 

This brand-new townhouse features high calibre architectural design. Combine this with luxury finishes and superior attention to detail for a unique experience directly opposite the Anglesea river and main beach.

Highlights include open plan living on the first floor that maximise the outlook while prioritising spacious, light filled liveability boasting river views and a connection to outdoor living. An extensive kitchen, with a butler's pantry, forms the natural focal point of the home where friends and family will love to gather. Sheltered outdoor living invites entertaining and relaxing and showcases the river views. The master suite, also on this level, is a welcoming retreat and includes plentiful storage, an en-suite with a touch of

Type : Townhouse
Land Size : 297 sqm
View : <https://www.greatoceanproperties.com.au/5857740>



Marty Maher
0352200000

[For full version visit the website](https://www.greatoceanproperties.com.au)

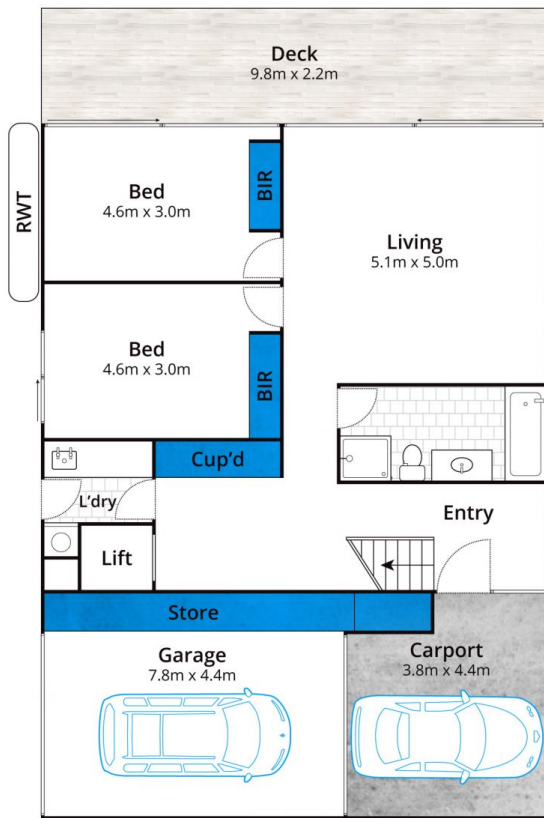

Ground Floor

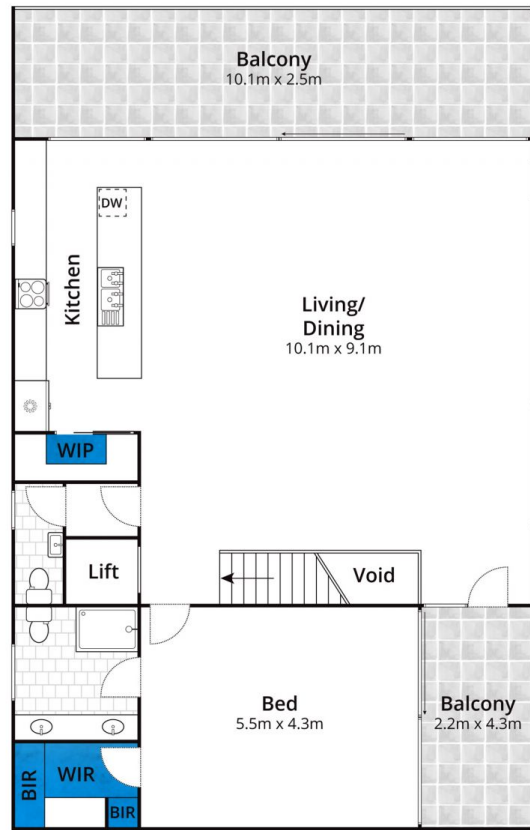

First Floor

Approx House Area 244m²

Whilst bwrn.com.au has made every attempt to ensure the accuracy of the floor plan contained here, measurements are approximate and no responsibility is taken for any error, omission, or mis-statement. This plan is for illustrative purposes only.

4/137 Great Ocean Road, Anglesea

