



23 McConnell Close ANGLESEA VIC

6 3 6

This once humble split-level beach house has been transformed into a stunning coastal property where easy living and effortless all year-round entertaining are the priority.

Blending a crisp modern aesthetic with natural tones and timber elements has produced a unique and character filled home. It features light filled open plan living on the uppermost level. Highlights here include a well-appointed kitchen featuring timber bench tops; a relaxed reading room or study; a freestanding wood fire to keep things cosy plus enviable flow to outdoor entertaining. The adjacent master bedroom includes an en-suite with a spa bath.

Downstairs, on the middle level, there are three bedrooms with built in robes; a central bathroom plus a large laundry. On the ground floor a second living area accommodates

Type : House
Land Size : 857 sqm
View : <https://www.greatoceanproperties.com.au/6008359>



Marty Maher
0352200000

[For full version visit the website](https://www.greatoceanproperties.com.au)

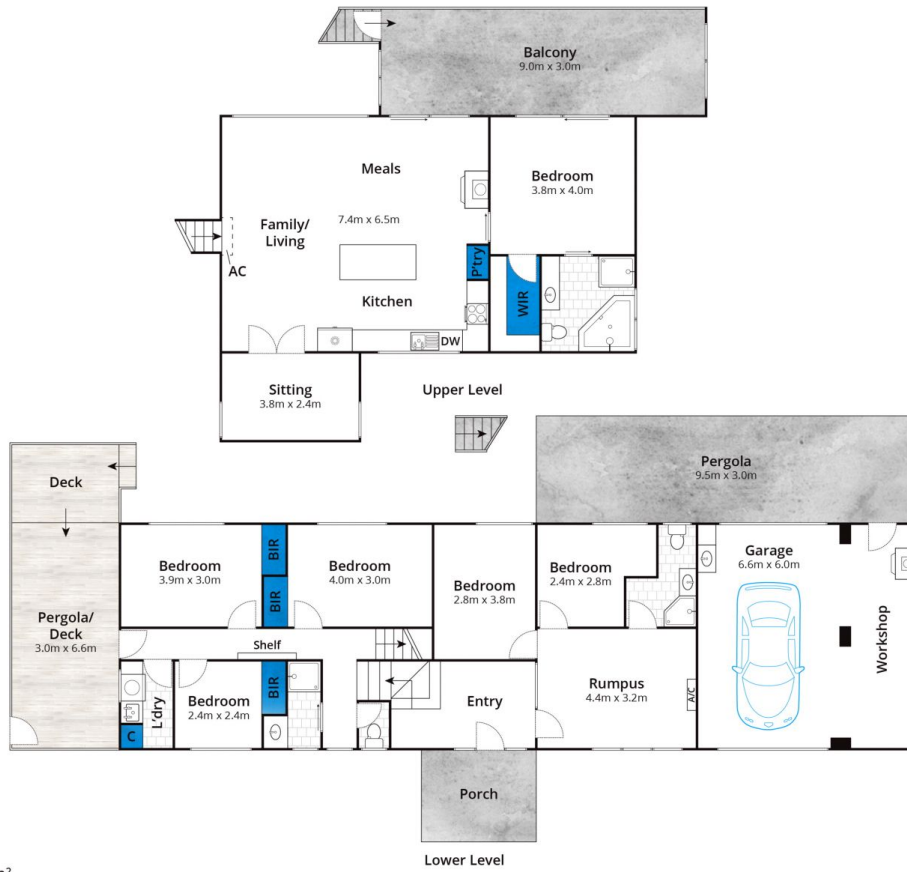

Approx House Area 224m²

Whilst bwrn.com.au has made every attempt to ensure the accuracy of the floor plan contained here, measurements are approximate and no responsibility is taken for any error, omission, or mis-statement. This plan is for illustrative purposes only.

23 Mcconnell Close, Anglesea

