

65 Central Avenue TORQUAY VIC

3 2 2

Centrally located in the heart of Torquay's "golden grid", this home was designed, built and crafted to showcase and exude ease of living. The understated sophistication of a neutral colour palette complements the greenery outside, forging a visual connection between indoors and out. Stacker doors reveal the alfresco - a private north-facing entertaining zone bordered by Birds of Paradise and easy-care landscaping.

High ceilings and fresh white interiors are complemented by warm-toned Tassie Oak flooring and stairs, while floating timber shelving add a beautiful accent to the stunning kitchen. The open plan kitchen, meals and living area balances function and style, fitted with quality Fisher and Paykel appliances, Caesarstone benchtops and a

Type : House
Land Size : 368 sqm
View : <https://www.greatoceanproperties.com.au/6145677>



Marty Maher
0352200000



Michelle McDonald
0352631100

[For full version visit the website](https://www.greatoceanproperties.com.au)

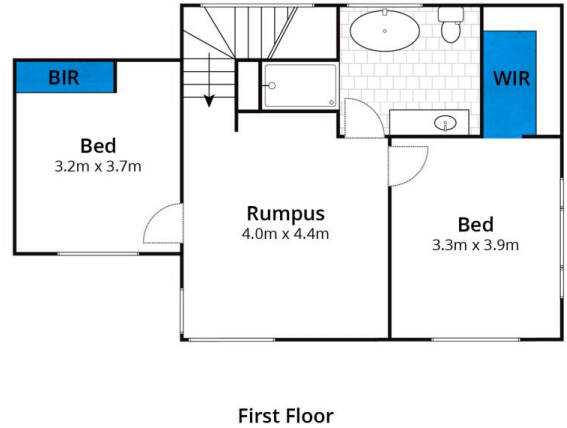
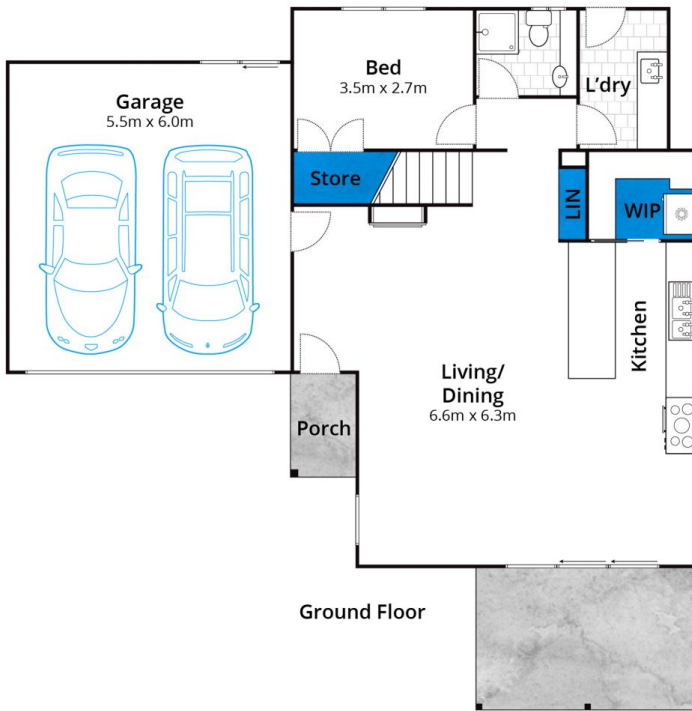

Approx. Area 181m²

Whilst bwrn.com.au has made every attempt to ensure the accuracy of the floor plan contained here, measurements are approximate and no responsibility is taken for any error, omission, or mis-statement. This plan is for illustrative purposes only.

65 Central Avenue, Torquay

