



## 25 Eagle Point Road BELLBRAE VIC

4 2 4

Welcome to 13 acres of nature filled tranquillity, seclusion and calm. This is a unique lifestyle opportunity where kookaburras are the soundtrack and the native wildlife provide the entertainment.

Just 10 minutes to Torquay, this property features a solid 1980s home with a flexible layout. Copious floor to ceiling glazing floods the home with natural light and showcases the garden and native bush setting. There are two separate and generous living areas. The sitting room flows to a conservatory and a sheltered north facing garden, and it includes an open fire. There are four bedrooms plus a study, the master has an en-suite and walk in-robe.

The practical considerations of hinterland living have all

**Type** : Acreage/Semi-Rural

**View** : <https://www.greatoceanproperties.com.au/6394346>



**Michelle McDonald**  
0352631100

[For full version visit the website](https://www.greatoceanproperties.com.au)

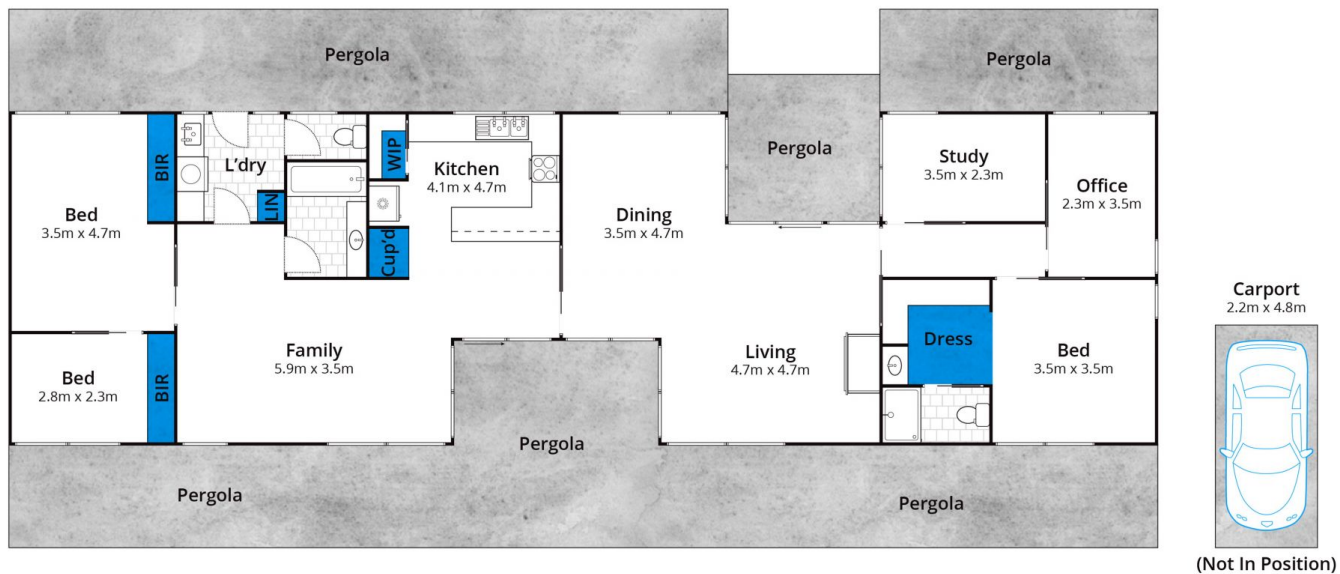

**25 Eagle Point Road, Bellbrae**

