



20 Point Addis Road BELLS BEACH VIC

3 2 2

The views hold your attention from a home that can effectively be described as a panorama, and create a sensation that defies description... Visual engagement with the landscape takes in the ocean, bush and Otways, with complete privacy no matter what the season.

This exclusive address gives easy access to the Great Ocean Road, bordered by the Pt Addis Marine National Park, Ironbark Basin and Great Otway National Park. This custom-built home on approx. 90 acres of countryside on Victoria's Surf Coast needs to be seen to be believed. Enjoy incredible ocean and hinterland views, the smell of the sea air fresh and the rumblings of the surf constant as the sets roll through.

Type : Acreage/Semi-Rural
Land Size : 90 Acres
View : <https://www.greatoceanproperties.com.au/6516593>



Marty Maher
0352200000

[For full version visit the website](https://www.greatoceanproperties.com.au)

<https://www.greatoceanproperties.com.au>

5220 0000

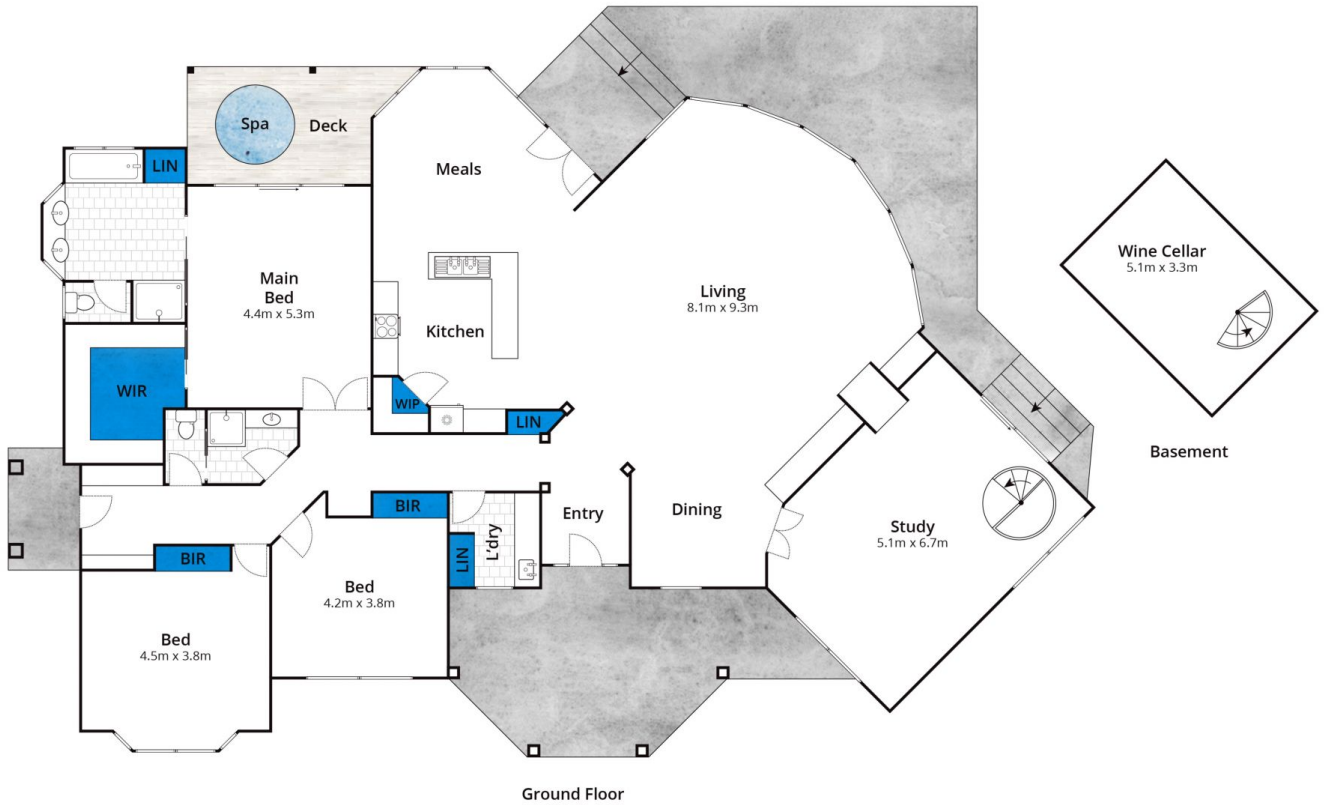

Approx House Area 312m²

Whilst bwrn.com.au has made every attempt to ensure the accuracy of the floor plan contained here, measurements are approximate and no responsibility is taken for any error, omission, or mis-statement. This plan is for illustrative purposes only.

20 Point Addis Road, Bells Beach

