



60 Albert Street LORNE VIC

3 1 10

Offers required by 22 November 2021

Situated on its own, totally private, 6-acre (app) promontory overlooking the stunning St. George River estuary and Great Otway National Park, this substantial, character filled residence will charm and delight you with both its unique setting and welcoming grace. Whether it's the great hall with its soaring ceilings, medieval castle sized open fireplace and overlooking mezzanine, or the cosy comfort of the second living area and 3 large bedrooms with their white rendered walls, this property is one where you can forget that the outside world exists and relax with family and friends. The property has hosted many large family weddings over the years and with its beautiful garden setting, its incredible outlook and substantial entertaining

Type : House
Land Size : 6 Acres
View : <https://www.greatoceanproperties.com.au/6680588>



Marty Maher
0352200000

[For full version visit the website](https://www.greatoceanproperties.com.au)

<https://www.greatoceanproperties.com.au>

5220 0000

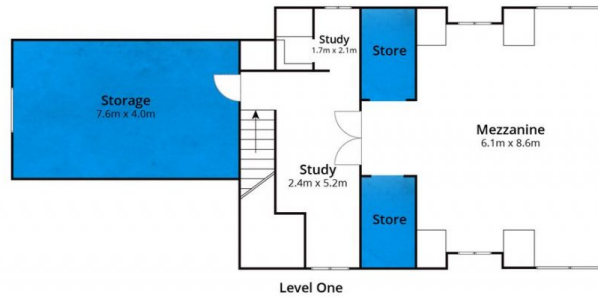

Whilst bwrm.com.au has made every attempt to ensure the accuracy of the floor plan contained here, measurements are approximate and no responsibility is taken for any error, omission, or mis-statement. This plan is for illustrative purposes only.

60 Albert Street, Lorne

