



**103 Noble Street ANGLESEA VIC**

4 🚗 2 🚗 2 🚗

Situated on an elevated corner allotment in one of Anglesea's most beautiful areas, this fully renovated home is your ticket to relaxing and unwinding. Spectacular vantage points take in views to the 18th fairway of the golf course, set against a panoramic backdrop of hinterland views that equally soothe and excite the senses. From here, you will chart your course for weekends spent golfing or exploring the walking trails beyond Anglesea.

Set amongst majestic gums and low maintenance native gardens on 1350 sqm (app), a stroll around the garden feels akin to a bushland reserve. Blissfully removed from summer tourism, you will have all the advantages of close proximity to the beach, river and community assets, with the peace and quiet of a neighbourhood location.

**Type** : House  
**Land Size** : 1350 sqm  
**View** : <https://www.greatoceanproperties.com.au/6731201>



**Marty Maher**  
**0352200000**

[For full version visit the website](https://www.greatoceanproperties.com.au)

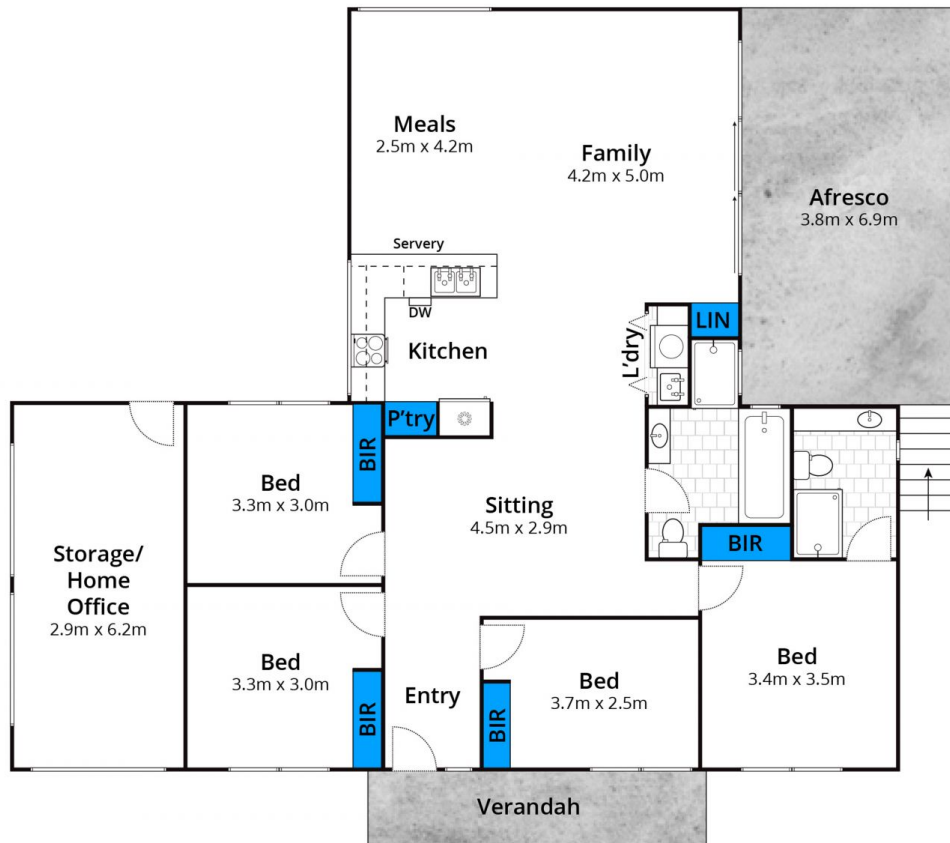

Whilst [bwrn.com.au](http://bwrn.com.au) has made every attempt to ensure the accuracy of the floor plan contained here, measurements are approximate and no responsibility is taken for any error, omission, or mis-statement. This plan is for illustrative purposes only.

## 103 Noble Street, Anglesea