



### 8 Manna Gum Close ANGLESEA VIC

3 2 2

Sunny and peaceful with a leafy garden outlook, 8 Manna Gum Close is tucked away in a quiet cul de sac. Situated in one of Anglesea's most beautiful and quiet areas, this friendly neighbourhood is a tight-knit community and offers a lovely sense of security. Blissfully removed from the bustling township, yet close enough to access all community amenities, this is a highly sought-after area. Within minutes you will be at the shops, beaches, golf course and all that Anglesea has to offer!

The flat allotment and single level floorplan champions accessibility, with no stairs into the property. Privacy-enhancing gardens can be enjoyed from the covered front veranda, blocking the street from view, and creating a natural haven. Meticulously kept and neatly

**Type** : House  
**Land Size** : 417 sqm  
**View** : <https://www.greatoceanproperties.com.au/6955930>



**Marty Maher**  
**0352200000**

[For full version visit the website](https://www.greatoceanproperties.com.au)

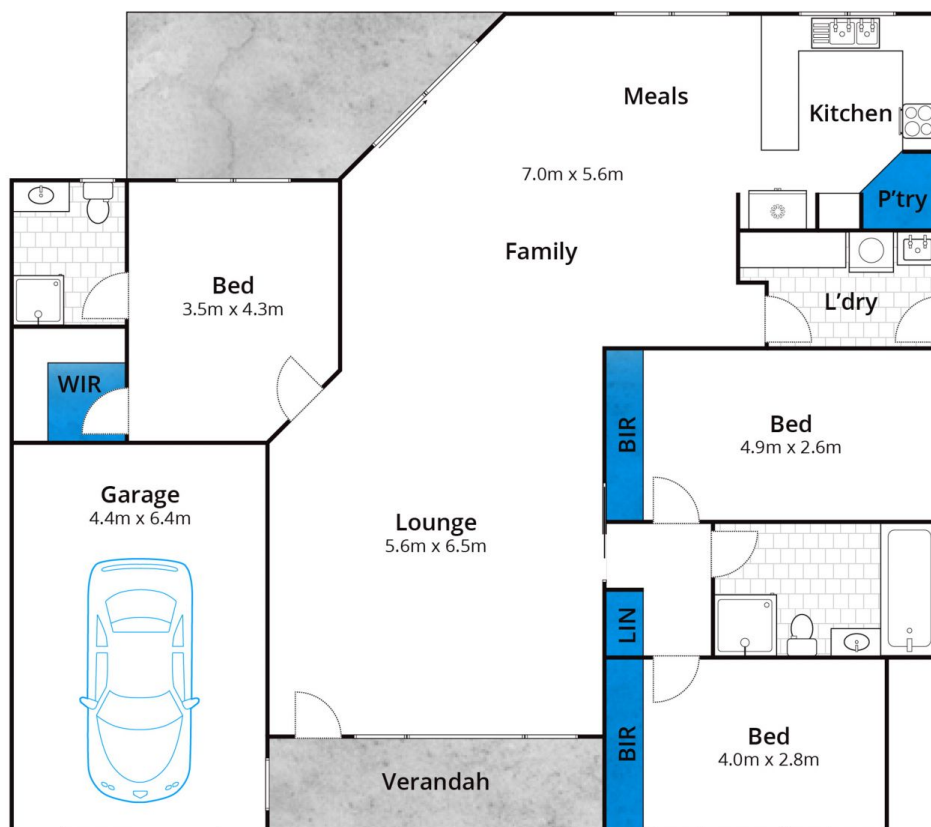

Approx. Area 183m<sup>2</sup>

Whilst [bwrm.com.au](http://bwrm.com.au) has made every attempt to ensure the accuracy of the floor plan contained here, measurements are approximate and no responsibility is taken for any error, omission, or mis-statement. This plan is for illustrative purposes only.

## 8 Manna Gum Close, Anglesea

