



10 Lawrencia Way ANGLESEA VIC

3 2 2

Light filled and presented in immaculate condition, this three bedroom home offers easy Anglesea living. Located in an established neighbourhood just moments from parkland, river walking trails and just a 5 minute stroll to the Anglesea shops, you have everything on your doorstep. The residence is 2 years old with all the modern amenities that you would expect. Comprising of a well appointed kitchen with open plan living and dining, spacious bedrooms all with built in robes, the master with walk in robe and ensuite, a central bathroom, laundry and lock up garage. The rear porch and low maintenance garden is the perfect spot to relax. Double vehicle lock up garage with remote roller door. Available for 12 month lease. Inspections available by appointment. Featuring:

Type : House
Price : \$ 700
Land Size : 370 sqm
View : <https://www.greatoceanproperties.com.au/7462923>



Michelle McDonald
 03 5263 1100

[For full version visit the website](https://www.greatoceanproperties.com.au)

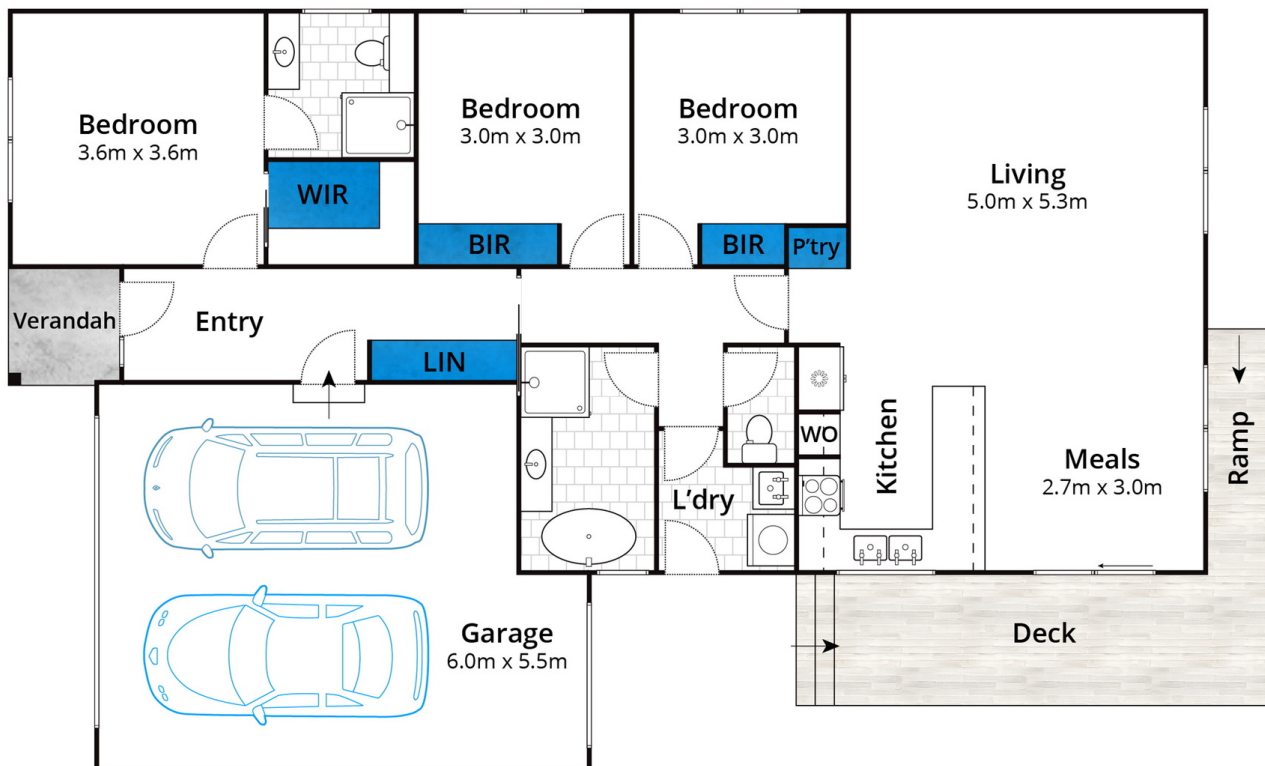

Whilst bwrn.com.au has made every attempt to ensure the accuracy of the floor plan contained here, measurements are approximate and no responsibility is taken for any error, omission, or mis-statement. This plan is for illustrative purposes only.

10 Lawrencina Way, Anglesea

