



1/13 Wray Street ANGLESEA VIC

3 **1** **1**

For those looking for a 'lock up and leave' property this brilliant freestanding townhouse is the perfect answer. Set in a very convenient location close to the main shopping area, the single level residence enjoys a Wray Street frontage plus excellent natural light into a north facing courtyard. The open plan of the living, kitchen and dining area takes full advantage of its northern aspect and is a delightful light filled space. One of only three townhouses and being the front property, the residence feels much more like a house rather than a townhouse. Accommodation is generous with 3 double bedrooms, all with built in robes. There is a single lock up garage, electric cooking, dishwasher and both a shower and bath in the bathroom. The rendered brick construction is low maintenance and ideal for the coastal environment. Set on

Type : Unit
Price : \$ 1,020,000
Land Size : 314.7 sqm
View : <https://www.greatoceanproperties.com.au/7646269>



Marty Maher
0352200000



Michelle McDonald
0352631100

[For full version visit the website](https://www.greatoceanproperties.com.au)

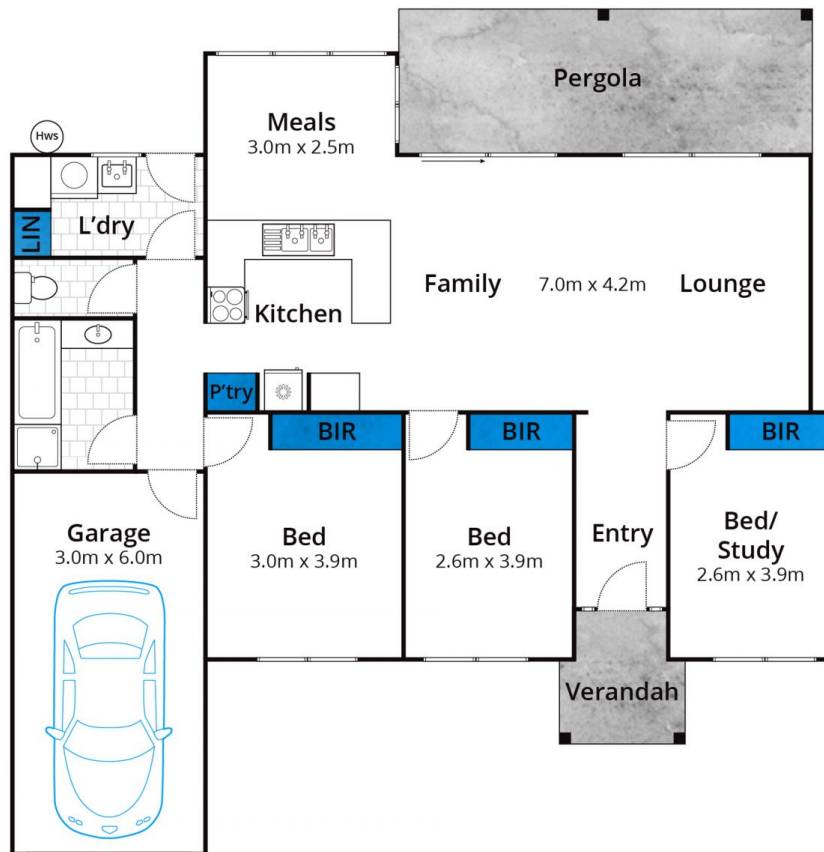

Whilst bwrn.com.au has made every attempt to ensure the accuracy of the floor plan contained here, measurements are approximate and no responsibility is taken for any error, omission, or mis-statement. This plan is for illustrative purposes only.

1/13 Wray Street, Anglesea

