



9 Tonge Street ANGLESEA VIC

3 1 2

Located in Anglesea's most sought after and tightly held precinct, this brilliant position enjoys direct access to the stunning Anglesea Main Beach and Surf Lifesaving Club. Set on a substantial 1440sqm (app) allotment, the current residence is just a placeholder for what will undoubtedly be the site of a beautiful new future residence and the property has been priced with this in mind. The position is simply superb, walking distance to all your needs including the beach, shops, cafes and river precinct. The contour is level so suitable for all age groups and particularly suited for those looking to build a high quality future residence that could potentially serve as their future permanent residence. The site has an excellent northern aspect and at 1440sqm (app) there is plenty of room to design a dream home for this brilliant location. The current residence is an Anglesea

Type : House
Price : \$ 1,450,000
Land Size : 1440 sqm
View : <https://www.greatoceanproperties.com.au/7646442>



Marty Maher
0352200000



Michelle McDonald
0352631100

[For full version visit the website](https://www.greatoceanproperties.com.au)

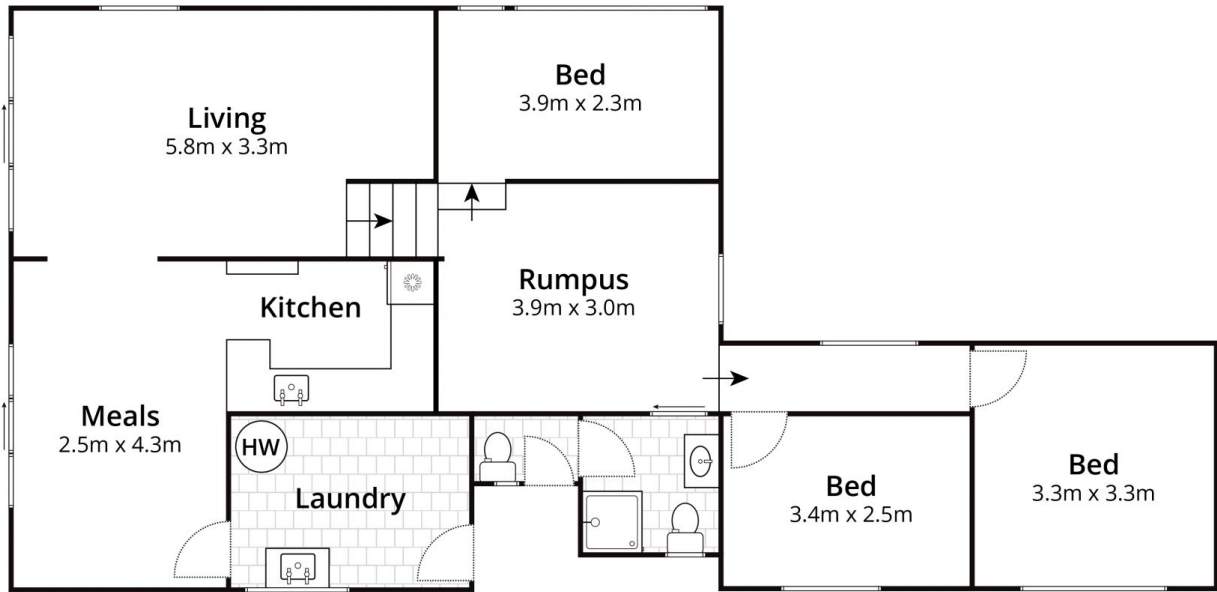

Whilst bwrn.com.au has made every attempt to ensure the accuracy of the floor plan contained here, measurements are approximate and no responsibility is taken for any error, omission, or mis-statement. This plan is for illustrative purposes only.

9 Tonge Street, Anglesea

