



45 Lialeeta Road FAIRHAVEN VIC

5 🏠 2 🚗 2 🚗

Offers required by 30 April 2024

Taking full advantage of its elevated position, this immaculately presented residence enjoys incredible ocean views all the way along the coast. You can even watch the surf break in front of the Fairhaven Surf Club. Set on a substantial 1135sqm (app) fully landscaped allotment the 5BR residence has enjoyed upgrades throughout its current ownership and is ready for a new owner to enjoy from day one. The large open plan living area takes full advantage of the stunning view and most people utter an involuntary Wow! upon entry. There is beautiful sun trap rear verandah and garden area that is a fantastic outdoor entertaining spot that is out of the wind and would be brilliant for breakfast in the morning sun. There is also a

Type : House
Land Size : 1135 sqm
View : <https://www.greatoceanproperties.com.au/7952978>



Marty Maher
0352200000



Mim Atkinson
0352200000

[For full version visit the website](https://www.greatoceanproperties.com.au)

<https://www.greatoceanproperties.com.au>

5220 0000

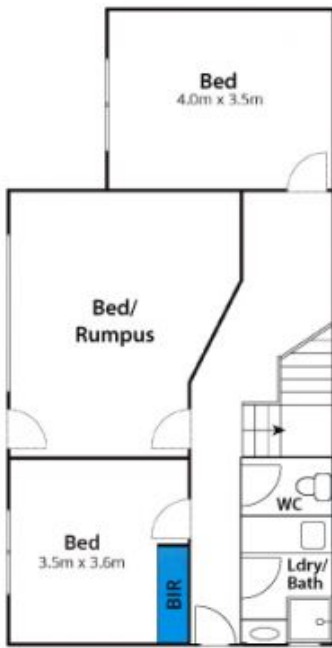

Ground Floor



First Floor

Whilst berm.com.au has made every attempt to ensure the accuracy of the floor plan contained here, measurements are approximate and no responsibility is taken for any error, omission, or mis-statement. This plan is for illustrative purposes only.

45 Lialeeta Road, Fairhaven

