



## 1 Costerman Terrace MARENGO VIC

5 3 5

This distinguished north-facing property, set on 1 acre, boasts delightful rural and garden views and has been meticulously maintained. This stunning Mount Gambier Limestone home is enveloped by lush gardens, mature trees, and manicured lawns, creating a serene oasis.

The home has high ceilings and expansive windows that fill the generous spaces with natural light, enhancing the modern design and picturesque surroundings. The heart of the home is a large and welcoming space, featuring a bright kitchen, meals, and family area that seamlessly flows out to a covered deck, perfect for entertaining, with access to the covered BBQ area. An adjacent TV nook with wood heater adds a cosy enclave to retreat to in those cooler winter months.

[For full version visit the website](https://www.greatoceanproperties.com.au)

**Type** : House  
**Price** : \$2,200,000  
**Land Size** : 1 Acres  
**View** : <https://www.greatoceanproperties.com.au/8173494>



**Gary Van Someren**  
0418550049



**James Aiken**  
0402339182

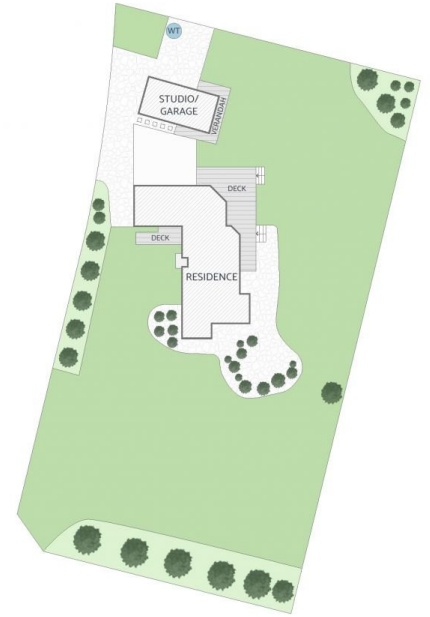
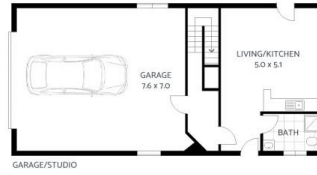
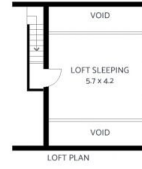

## 1 Costerman Terrace, MARENGO

ARTIST'S IMPRESSION ONLY: While every attempt has been made to ensure the accuracy of this floor plan's areas and measurements of doors, windows, rooms and all other items are approximate and no responsibility is taken for any error, omission, or mis-statement. This plan is for illustrative purposes only and should only be used as such by any prospective purchaser. **Floor Plan by: RealEstatefloorPlans.com.au**



INTERNAL:	266m <sup>2</sup>
EXTERNAL:	101m <sup>2</sup>
GARAGE/STUDIO:	154m <sup>2</sup>
TOTAL:	521m <sup>2</sup>
LAND SIZE:	4001m <sup>2</sup>

greateoceanproperties